

10 9 8 7 6 5 4 3 2 1

F

E

D

C

B

A

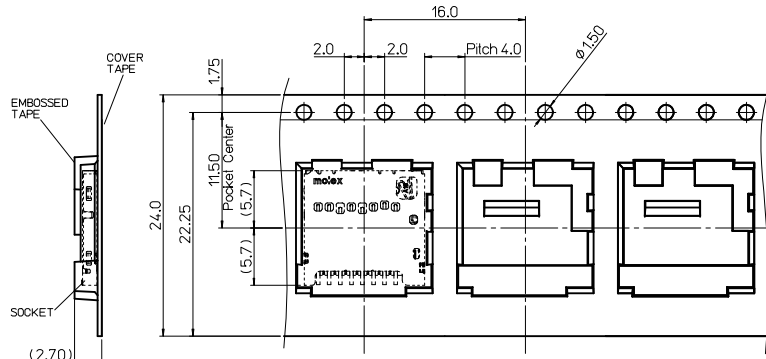

TOP VIEW OF EMBOSS TAPE

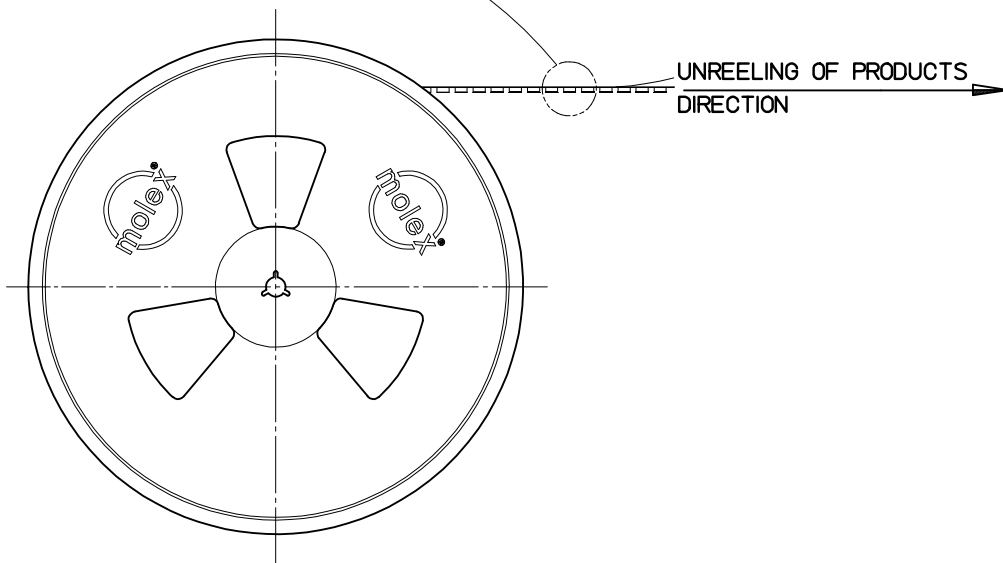
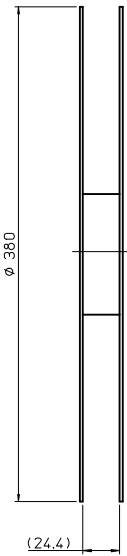

NOTES

- 1. QUANTITY OF PRODUCTS : 2,000 PCS / 1 REEL
- 2. LEAD LENGTH

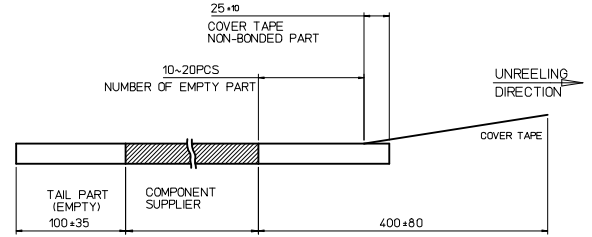

- 3. PEELING OFF FORCE OF COVER TAPE : 0.1N~0.59N(10.2~60gf)
(PEELING DIRECTION AS BELOW)
- PEELING OFF SPEED : 300mm/Min.(Ref.)

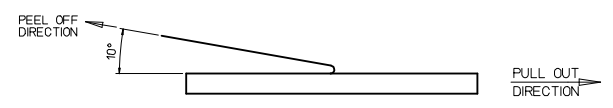

REVISED EC NO: KOR2013-0028 DRWN: I.CYANG CHKD: APPR: YSKIM02 2012/08/25 2012/09/04	QUALITY SYMBOLS ▽=0 ◻=0	GENERAL TOLERANCES (UNLESS SPECIFIED)		DIMENSION STYLE MM ONLY		SCALE 2/1	DESIGN UNITS METRIC	THIRD ANGLE PROJECTION	
			mm	INCH	DRAWN BY	DATE	TITLE		
		4 PLACES	± ---	± ---	IC.YANG	2008.10.01	MICROSD CARD SOCKET		
		3 PLACES	± 0.1	± ---	CHECKED BY	DATE	PUSH-PULL 1.42H		
			2 PLACES	± 0.1	± ---	SH.CHU	2008.10.02	NORMAL TYPE	
			1 PLACE	± 0.2	± ---	APPROVED BY	DATE	MOLEX MOLEX INCORPORATED	
			ANGULAR ± 1 °			SJ.SEH	2008.10.02	DOCUMENT NO. SD-104031-001	
			DRAFT WHERE APPLICABLE MUST REMAIN WITHIN DIMENSIONS			MATERIAL NO.		SHEET NO. 2 OF 2	
					SEE SHEET 1	THIS DRAWING CONTAINS INFORMATION THAT IS PROPRIETARY TO MOLEX INCORPORATED AND SHOULD NOT BE USED WITHOUT WRITTEN PERMISSION			

9 8 7 6 5 4 3 2 1